

6-0	DISTRICT	COUNTY			TOWNSHIP			BOROUGH			ROUTE		SECTION		TOTAL SHEETS	
		PHILADELPHIA			PHILADELPHIA						-		-		16	
WBS ELEMENT																
	T/P	SYS	WO				SPUR	PHA	SECTION			ORG			PRG	P_C

SCHUYLKILL RIVER DEVELOPMENT CORPORATION

LANDSCAPE DRAWINGS

FOR

CONSTRUCTION

OF

THE SCHUYLKILL RIVER TRAIL EXTENSION - SOUTH STREET TO CHRISTIAN STREET

IN PHILADELPHIA COUNTY, PENNSYLVANIA

FROM STA. 99+56.00 TO STA. 113+68.00 LENGTH 1412.00 FT, 0.27 MI.

DESIGN DESIGNATION

HIGHWAY CLASSIFICATION	- SHARED USE PATH
DESIGN SPEED	- 20 MPH
PAVEMENT WIDTH	- 12'-0"
SHOULDER WIDTH	- 2'-0" (NON-PAVED)

PREPARED BY:
GROUND RECONSIDERED
230 S. BROAD STREET, SUITE 604
PHILADELPHIA, PA 19102
215-790-0727

SEAL:

PA LA002810 12/2016
REGISTRATION NO. DATE

DATE: DECEMBER, 2016

KEY	ITEM	NOTES	DETAIL (#/SHEET)
PAVING			
	SHARED USE PATH	REFER TO CIVIL DRAWINGS	
P2	PERMEABLE PAVERS	REFER TO SHEET 6 OF 16 FOR LAYOUT; REFER TO CIVIL DRAWINGS FOR DETAILS	
SITE FURNISHING			
B1	BENCH, WITH BACK	SCHUYLKILL BANKS STANDARD 4' BENCH: BRP BY BISON (MFR.) PRODUCT # PA-121-48-EM, POWDER-COAT BLACK	1/13 & 2/13
B2	BENCH, BACKLESS	SCHUYLKILL BANKS STANDARD 4' BACKLESS BENCH: BRP BY BISON (MFR.) PRODUCT # PA-122-48-EM, POWDER-COAT BLACK	1/13 & 2/13
BR1	BIKE RACKS	"HIGH WHEELER" BIKE RACK - OWNER FURNISHED, CONTRACTOR INSTALLED	4/13
BR2	BIKE RACKS	CITY STANDARD INVERTED-U, SURFACE-MOUNT	3/13
T1	TRASH RECEPTACLES	SCHUYLKILL BANKS STANDARD TRASH RECEPTACLE. REFER TO SIM, DETAIL 5/SHEET 13 FOR RECEPTACLES IN PLANTING AREAS. EXTEND TOP OF FOOTER 1" ABOVE FINISHED GRADE FOR RECEPTACLES IN PLANTING AREAS	5/13
	SIGNS	OWNER FURNISHED SCHUYLKILL BANKS STANDARD SIGNAGE; EMBEDDED MOUNT IN C.I.P. CONC. FOOTING	
	RAILING	REFER TO CIVIL DRAWINGS	
	BOULDERS	PA FIELDSTONE BOULDERS	

EXISTING SITE IMPROVEMENTS	
	POLE LIGHT
	PAD-MOUNTED RECEPTACLE
	CHAINLINK FENCE

2

MATERIAL & FURNISHING SCHEDULE

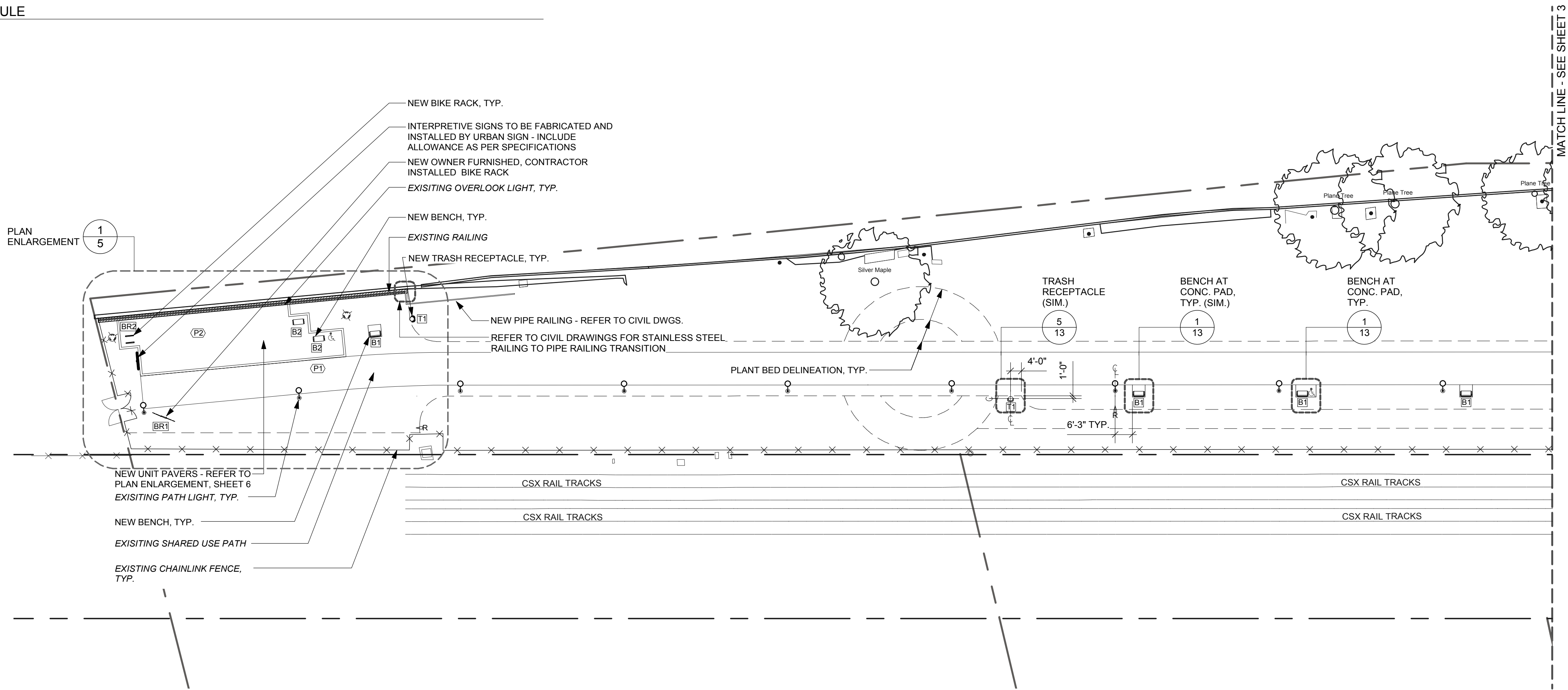

HORIZONTAL 0 25 50 FEET

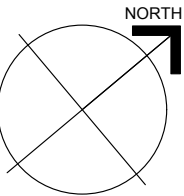

SEAL:

PA LA002810 12/2016
REGISTRATION NO. DATE
PREPARED BY:
Ground Reconsidered
LANDSCAPE ARCHITECT:
GROUND RECONSIDERED
230 S. BROAD ST., STE. 604
PHILADELPHIA, PA 19102
PH: 215.790.0727
www.groundreconsidered.com

KEY	ITEM	NOTES	DETAIL (#/SHEET)
PAVING			
	SHARED USE PATH	REFER TO CIVIL DRAWINGS	
P2	PERMEABLE PAVERS	REFER TO SHEET 6 OF 16 FOR LAYOUT; REFER TO CIVIL DRAWINGS FOR DETAILS	
SITE FURNISHING			
B1	BENCH, WITH BACK	SCHUYLKILL BANKS STANDARD 4' BENCH: BRP BY BISON (MFR.) PRODUCT # PA-121-48-EM, POWDER-COAT BLACK	1/13 & 2/13
B2	BENCH, BACKLESS	SCHUYLKILL BANKS STANDARD 4' BACKLESS BENCH: BRP BY BISON (MFR.) PRODUCT # PA-122-48-EM, POWDER-COAT BLACK	1/13 & 2/13
BR1	BIKE RACKS	"HIGH WHEELER" BIKE RACK - OWNER FURNISHED, CONTRACTOR INSTALLED	4/13
BR2	BIKE RACKS	CITY STANDARD INVERTED-U, SURFACE-MOUNT	3/13
T1	TRASH RECEPTACLES	SCHUYLKILL BANKS STANDARD TRASH RECEPTACLE. REFER TO SIM, DETAIL 5/SHEET 13 FOR RECEPTACLES IN PLANTING AREAS. EXTEND TOP OF FOOTER 1" ABOVE FINISHED GRADE FOR RECEPTACLES IN PLANTING AREAS	5/13
	SIGNS	OWNER FURNISHED SCHUYLKILL BANKS STANDARD SIGNAGE; EMBEDDED MOUNT IN C.I.P. CONC. FOOTING	
	RAILING	REFER TO CIVIL DRAWINGS	
	BOULDERS	PA FIELDSTONE BOULDERS - LAYOUT TO BE BE DONE IN FIELD WITH LANDSCAPE ARCHITECT	

EXISTING SITE IMPROVEMENTS	
	POLE LIGHT
	PAD-MOUNTED RECEPTACLE
	CHAINLINK FENCE

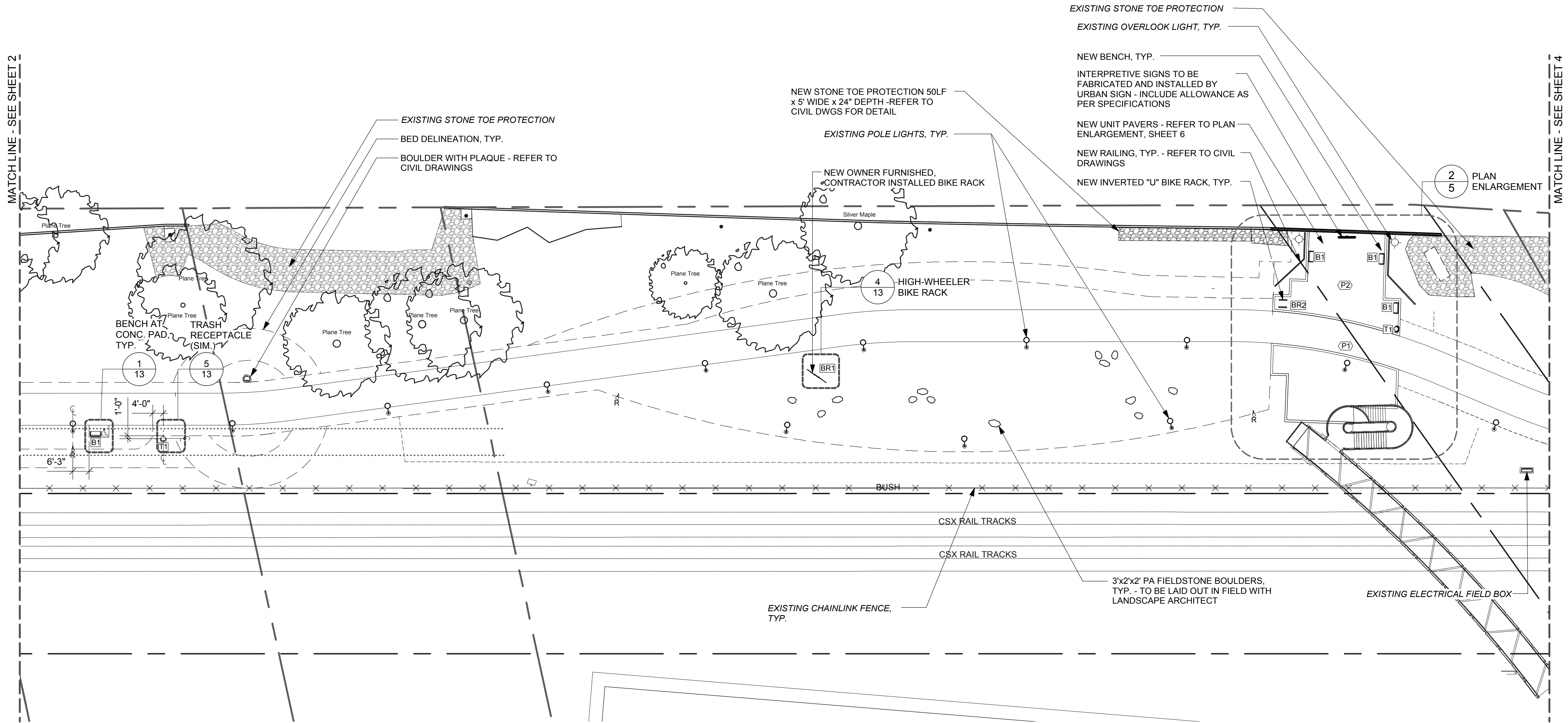

DISTRICT	COUNTY	ROUTE	SECTION	SHEET	
6-0	PHILADELPHIA	-		3 OF 16	
CITY OF PHILADELPHIA					
REVISION NUMBER	REVISIONS			DATE	BY

SCHUYLKILL RIVER TRAIL EXTENSION
SITE MATERIALS & FURNISHINGS PLAN

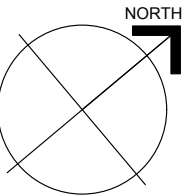

HORIZONTAL 0 25 50 FEET

SEAL:

PA LA002810 12/2016
REGISTRATION NO. DATE

PREPARED BY:
Ground Reconsidered

LANDSCAPE ARCHITECT:
GROUND RECONSIDERED
230 S. BROAD ST., STE. 604
PHILADELPHIA, PA 19102
PH: 215.790.0727
www.groundreconsidered.com

KEY	ITEM	NOTES	DETAIL (#/SHEET)
PAVING			
	SHARED USE PATH	REFER TO CIVIL DRAWINGS	
P2	PERMEABLE PAVERS	REFER TO SHEET 6 OF 16 FOR LAYOUT; REFER TO CIVIL DRAWINGS FOR DETAILS	
SITE FURNISHING			
B1	BENCH, WITH BACK	SCHUYLKILL BANKS STANDARD 4' BENCH: BRP BY BISON (MFR.) PRODUCT # PA-121-48-EM, POWDER-COAT BLACK	1/13 & 2/13
B2	BENCH, BACKLESS	SCHUYLKILL BANKS STANDARD 4' BACKLESS BENCH: BRP BY BISON (MFR.) PRODUCT # PA-122-48-EM, POWDER-COAT BLACK	1/13 & 2/13
BR1	BIKE RACKS	"HIGH WHEELER" BIKE RACK - OWNER FURNISHED, CONTRACTOR INSTALLED	4/13
BR2	BIKE RACKS	CITY STANDARD INVERTED-U, SURFACE-MOUNT	3/13
T1	TRASH RECEPTACLES	SCHUYLKILL BANKS STANDARD TRASH RECEPTACLE. REFER TO SIM. DETAIL 5/SHEET 13 FOR RECEPTACLES IN PLANTING AREAS. EXTEND TOP OF FOOTER 1" ABOVE FINISHED GRADE FOR RECEPTACLES IN PLANTING AREAS	5/13
	SIGNS	OWNER FURNISHED SCHUYLKILL BANKS STANDARD SIGNAGE; EMBEDDED MOUNT IN C.I.P. CONC. FOOTING	
	RAILING	REFER TO CIVIL DRAWINGS	
	BOULDERS	PA FIELDSTONE BOULDERS	

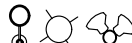
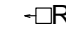
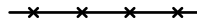
EXISTING SITE IMPROVEMENTS	
	POLE LIGHT
	PAD-MOUNTED RECEPTACLE
	CHAINLINK FENCE

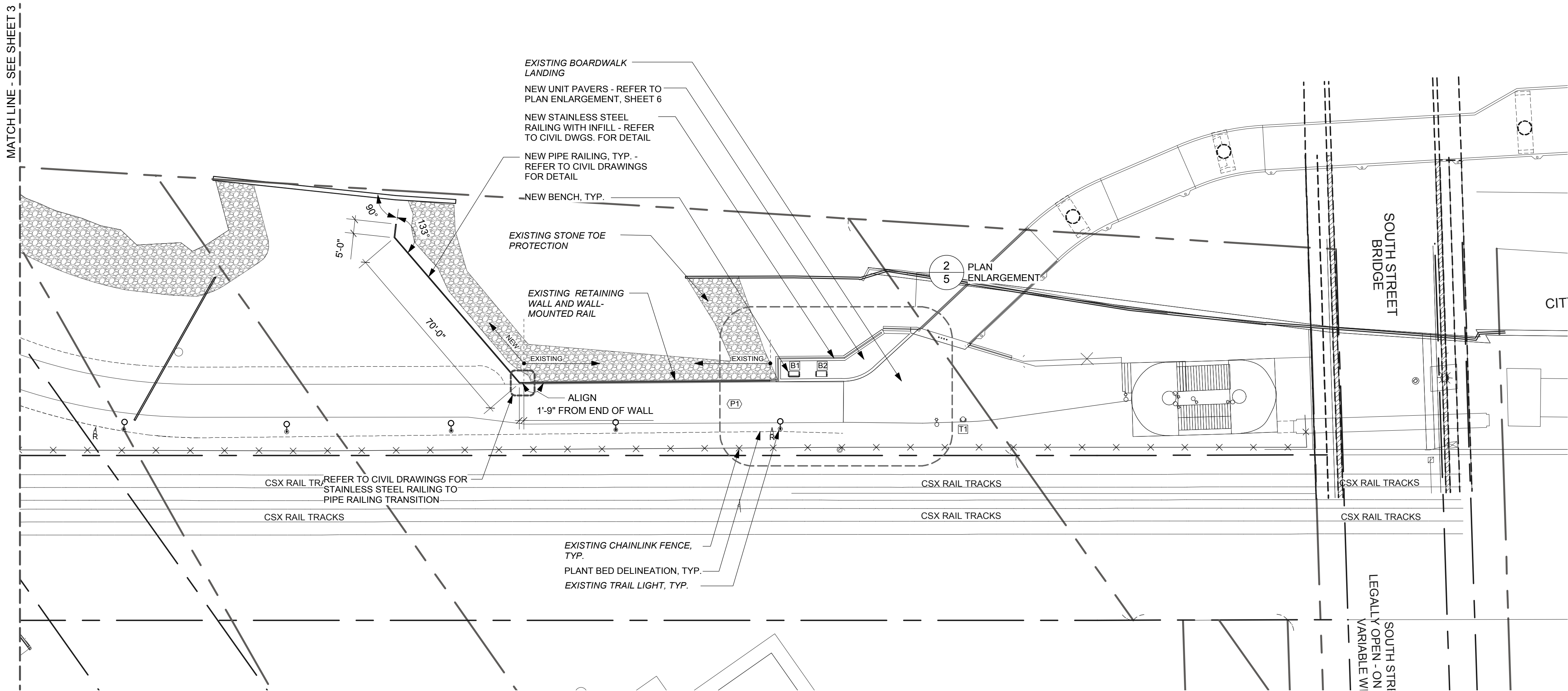

DISTRICT	COUNTY	ROUTE	SECTION	SHEET	
6-0	PHILADELPHIA	-		4 OF 16	
CITY OF PHILADELPHIA					
REVISION NUMBER	REVISIONS			DATE	BY

SCHUYLKILL RIVER TRAIL EXTENSION
SITE MATERIALS & FURNISHINGS PLAN

HORIZONTAL 0 25 50 FEET

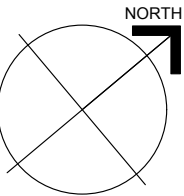

SEAL: 

PA LA002810 12/2016
REGISTRATION NO. DATE

PREPARED BY: **Reconsidered**

Ground

LANDSCAPE ARCHITECT:
GROUND RECONSIDERED
230 S. BROAD ST., STE. 604
PHILADELPHIA, PA 19102
PH: 215.790.0727
www.groundreconsidered.com

DISTRICT	COUNTY	ROUTE	SECTION	SHEET	
6-0	PHILADELPHIA	-		5 OF 16	
CITY OF PHILADELPHIA					
REVISION NUMBER	REVISIONS			DATE	BY

SCHUYLKILL RIVER TRAIL EXTENSION
SITE MATERIALS & FURNISHINGS - PLAN ENLARGEMENTS

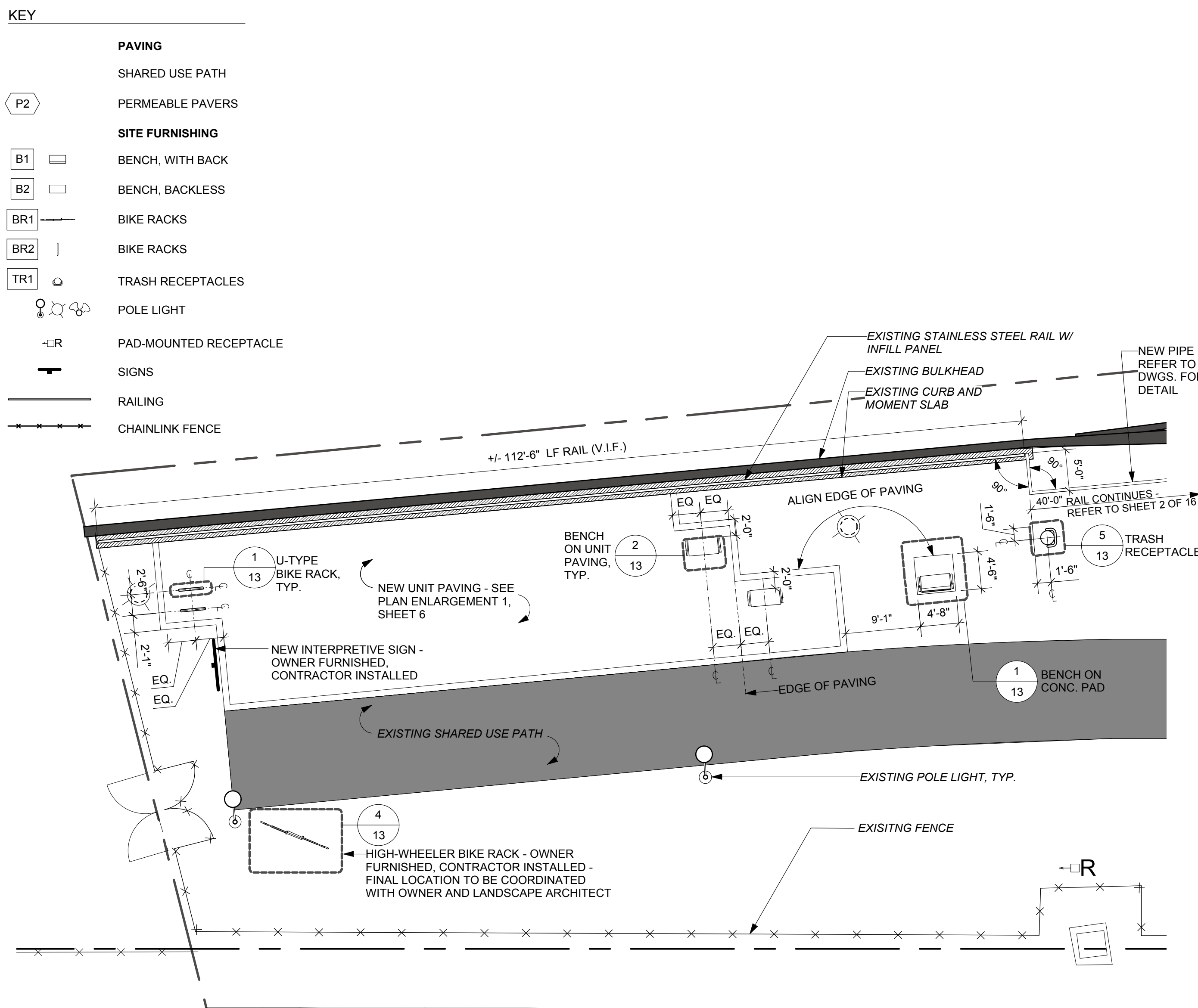

1 SOUTH OVERLOOK - PLAN ENLARGEMENT
5 SCALE: 1"=10'-0"

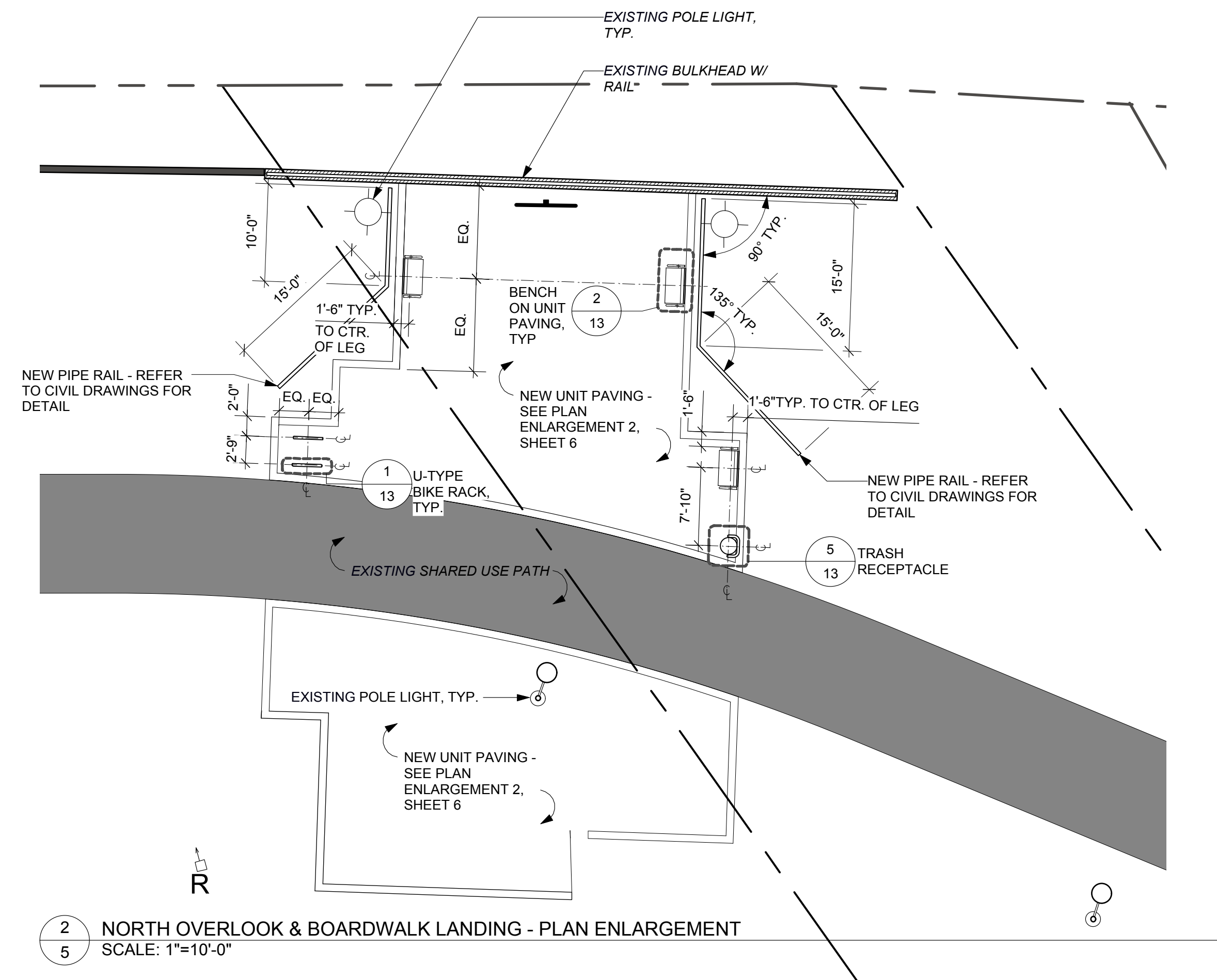

2 NORTH OVERLOOK & BOARDWALK LANDING - PLAN ENLARGEMENT
5 SCALE: 1"=10'-0"

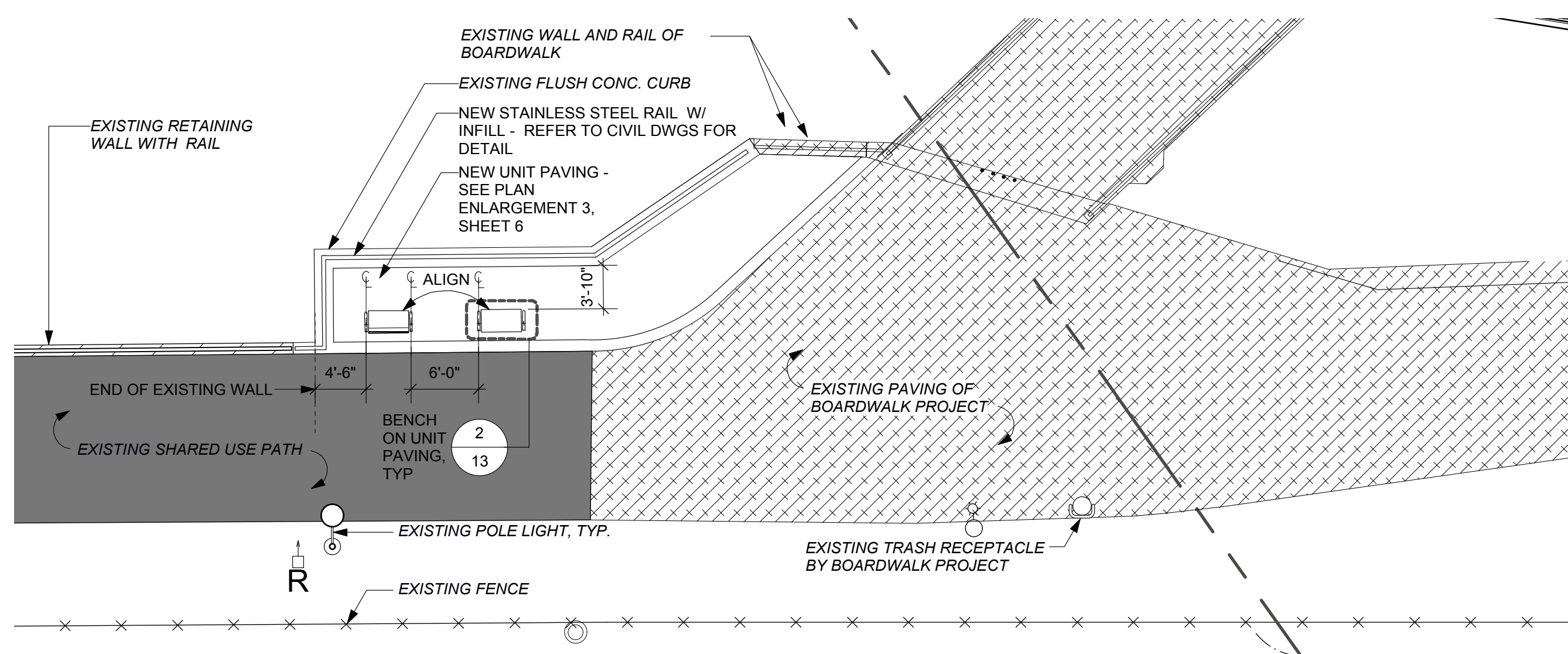

3 BOARDWALK LANDING - PLAN ENLARGEMENT
5 SCALE: 1"=10'-0"

NOTE:

CONTRACTOR TO VERIFY-IN-FIELD ALL EXISTING CURB AND PROPOSED RAIL DIMENSIONS. CONTRACTOR TO PROVIDE RAILING LAYOUT PLANS AS PART OF SHOP DRAWINGS, IN ADDITION TO AND AS PART OF ALL OTHER REQUIRED INFORMATION IN ACCORDANCE WITH THE SPECIFICATIONS AND OTHER CONTRACT DOCUMENTS. CONTRACTOR TO PROVIDE SHOP DRAWINGS FOR EACH RAILING TYPE AND LOCATION FOR SRDC REVIEW AND APPROVAL PRIOR TO RELEASE OF FABRICATION FOR RAILS.

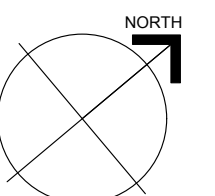

SEAL:



PA LA002810

2/2016

REGISTRATION NO.

REPAIRED BY:

Reconsidered

Ground Reconsidered

LANDSCAPE ARCHITECT:

LANDSCAPE ARCHITECT.
GROUND RECONSIDERED

230 S. BROAD ST., STE. 604
NEW BEDFORD, MA 01905

PHILADELPHIA, PA 19102
PH: 215 790 0727

www.groundreconsidered.com

SCHUYLKILL RIVER TRAIL EXTENSION
PAVING PLAN ENLARGEMENTS

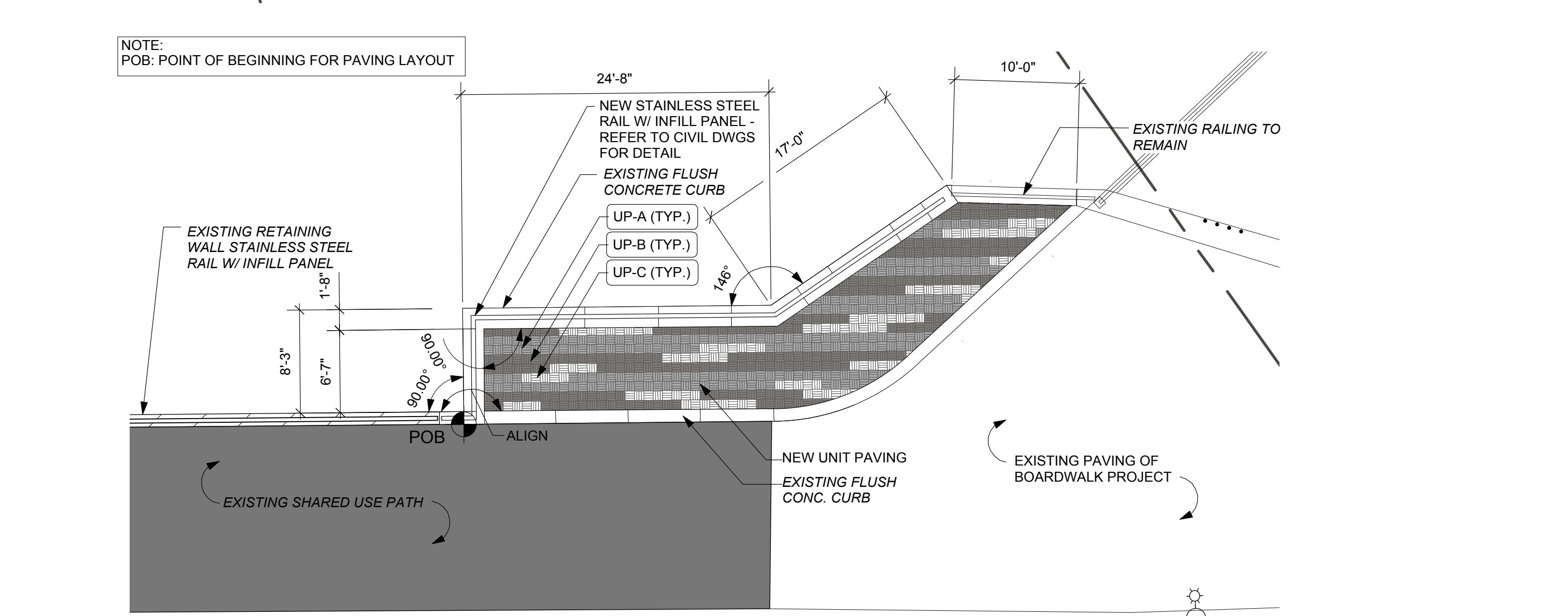

	PAVING
UP-A	PERMEABLE UNIT PAVING, LIGHT BLEND
UP-B	PERMEABLE UNIT PAVING, MEDIUM BLEND
UP-C	PERMEABLE UNIT PAVING, DARK BLEND



PA LA002810	12/2016
REGISTRATION NO.	DATE
PREPARED BY: Ground Reconsidered LANDSCAPE ARCHITECT: GROUND RECONSIDERED 230 S. BROAD ST., STE. 604 PHILADELPHIA, PA 19102 PH: 215.790.0727 www.groundreconsidered.com	

DISTRICT	COUNTY	ROUTE	SECTION	SHEET	
6-0	PHILADELPHIA	-		7 OF 16	
CITY OF PHILADELPHIA					
REVISION NUMBER	REVISIONS			DATE	BY

SCHUYLKILL RIVER TRAIL EXTENSION
PLANTING PLAN - TREES

Qty.	Key	Botanical Name	Common Name	Size	Spacing	Notes
CONIFEROUS TREES						
2	TD1	<i>Taxodium distichum</i>	Common Baldcypress	12-ft	As Shown	Specimen Quality, B&B
11	TD2	<i>Taxodium distichum</i>	Common Baldcypress	16-ft	As Shown	Specimen Quality, B&B
DECIDUOUS CANOPY TREES						
1	AR	<i>Acer rubrum</i>	Red Maple	2-1/2"-3" cal.	As Shown	Specimen Quality, B&B
1	ARC	<i>Acer rubrum</i> (multi-stem)	Red Maple	16-ft		Specimen Quality, B&B, Multi-Stem
28	BN1	<i>Betula nigra</i> (multi-stem)	River Birch	12-ft		Specimen Quality, B&B, Multi-Stem
1	BN2	<i>Betula nigra</i> (multi-stem)	River Birch	16-ft		Specimen Quality, B&B, Multi-Stem
1	CO1	<i>Celtis occidentalis</i>	Hackberry	2-1/2"-3" cal.		Specimen Quality, B&B
1	CO2	<i>Celtis occidentalis</i>	Hackberry	3-1/2" cal.		Specimen Quality, B&B
4	GT1	<i>Gleditsia tricanthos</i> 'Skycole'	Skyline Honeylocust	2-1/2"-3" cal.		Specimen Quality, B&B
3	GT2	<i>Gleditsia tricanthos</i> 'Skycole'	Skyline Honeylocust	3-1/2" cal.		Specimen Quality, B&B
3	LS1	<i>Liquidambar styraciflua</i> 'Ward'	Cherokee Sweetgum	2-1/2"-3" cal.		Specimen Quality, B&B
2	LS2	<i>Liquidambar styraciflua</i> 'Ward'	Cherokee Sweetgum	3-1/2" cal.		Specimen Quality, B&B
2	LT1	<i>Liriodendron tulipifera</i>	Tuliptree	2-1/2"-3" cal.		Specimen Quality, B&B
1	LT2	<i>Liriodendron tulipifera</i>	Tuliptree	3-1/2" cal.		Specimen Quality, B&B
2	LT3	<i>Liriodendron tulipifera</i>	Tuliptree	3-1/2" cal.		Specimen Quality, B&B
1	LT4	<i>Liriodendron tulipifera</i>	Tuliptree	5" cal.		Specimen Quality, B&B
4	NS1	<i>Nyssa sylvatica</i>	Black gum	2-1/2"-3" cal.		Specimen Quality, B&B
1	NS2	<i>Nyssa sylvatica</i>	Black gum	3-1/2" cal.		Specimen Quality, B&B
7	PO1	<i>Platanus occidentalis</i>	American Planetree	2-1/2"-3" cal.		Specimen Quality, B&B
5	PO2	<i>Platanus occidentalis</i>	American Planetree	3-1/2" cal.		Specimen Quality, B&B
1	QA	<i>Quercus alba</i>	White Oak	2-1/2"-3" cal.		Specimen Quality, B&B
3	QB1	<i>Quercus bicolor</i>	Swamp White Oak	2-1/2"-3" cal.		Specimen Quality, B&B
1	QB2	<i>Quercus bicolor</i>	Swamp White Oak	3-1/2" cal.		Specimen Quality, B&B
3	QPA	<i>Quercus palustris</i>	Pin Oak	2-1/2"-3" cal.		Specimen Quality, B&B
4	QPH	<i>Quercus phellos</i>	Willow Oak	2-1/2"-3" cal.		Specimen Quality, B&B
1	QM	<i>Quercus macrocarpa</i>	Bur Oak	2-1/2"-3" cal.		Specimen Quality, B&B
2	QR2	<i>Quercus rubra</i>	Red Oak	3-1/2" cal.		Specimen Quality, B&B
DECIDUOUS UNDERSTORY TREES						
6	AC	<i>Amelanchier canadensis</i>	Serviceberry	10-12' m.s.	As Shown	Specimen Quality, B&B, Multi-Stem
11	CC1	<i>Cercis canadensis</i>	Eastern Redbud	2-1/2"-3" cal.		Specimen Quality, B&B, Single stem
3	CC2	<i>Cercis candaensis</i>	Eastern Redbud	10-12' m.s.		Specimen Quality, B&B, Multi-Stem
5	CV	<i>Chioanthus virginicus</i>	Fringetree	10-12' m.s.		Specimen Quality, B&B, Multi-Stem

GENERAL NOTES:
1. REFER TO PLANTING DETAILS ON SHEET 14 FOR MIXED BED PLANTINGS AND TREE PLANTING.

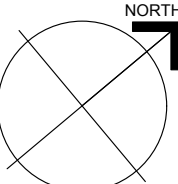
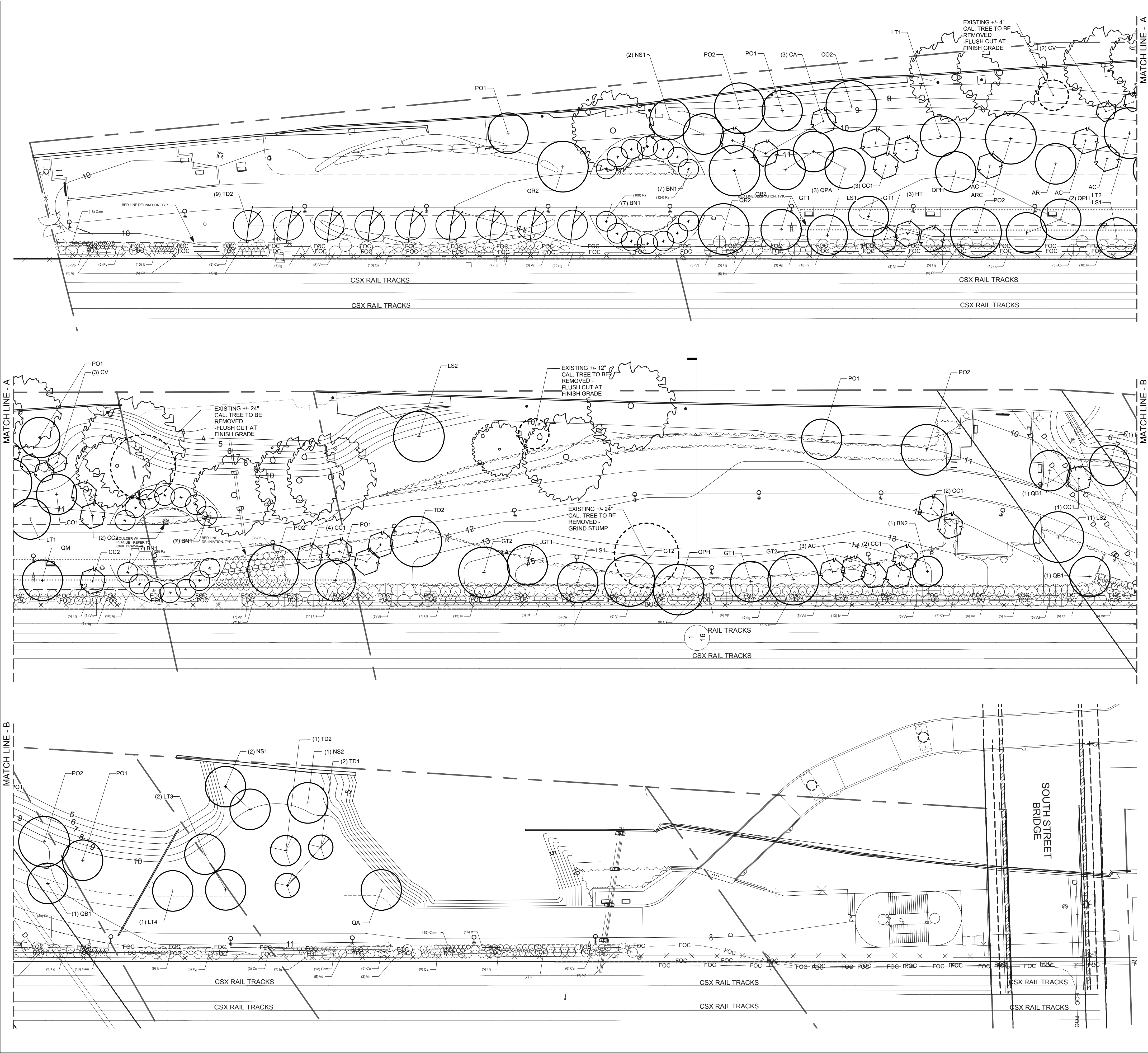





PA LA002810 12/2016
REGISTRATION NO. DATE
PREPARED BY:
Reconsidered Ground
LANDSCAPE ARCHITECT:
GROUND RECONSIDERED
230 S. BROAD ST., STE. 604
PHILADELPHIA, PA 19102
PH: 215.790.0727
www.groundreconsidered.com

PLANT SCHEDULE

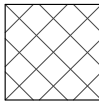
Qty.	Key	Botanical Name	Common Name	Size	Spacing	Notes
3	CA	<i>Cornus alternifolia</i>	Pagoda Dogwood	10-12' m.s.		Specimen Quality, B&B, Multi-Stem
3	HT	<i>Halesia tetraptera</i>	Carolina Silverbell	10-12' m.s.	•	Specimen Quality, B&B, Multi-Stem
SHRUBS						
19	Ap	<i>Aesculus parviflora</i>	Bottlebrush Buckeye	4-5', #10	As Shown	
13	Cf	<i>Calycanthus floridus</i>	Sweetshrub	4-5', #10		
58	Cam	<i>Ceanothus americanus</i>	New Jersey Tea	18-24", #3		
12	Cle	<i>Clethra alnifolia</i>	Summersweet	24-36", #5		
45	Ca	<i>Cornus amomum</i>	Silky dogwood	36-48", #7		
49	Cs	<i>Cornus sericea</i>	Red Osier Dogwood	36-48", #7		
38	Fg	<i>Fothergilla gardenii</i>	Dwarf Fothergilla	36-48", #7		
15	Hq	<i>Hydrangea quercifolia</i>	Oakleaf Hydrangea	36-48", #7		
91	Ig	<i>Ilex glabra</i>	Inkberry	36-48", #7		
		alt. <i>Ilex glabra</i> 'Shamrock'	Shamrock Inkberry	18-24", #5		
67	Iv	<i>Ilex verticillata</i>	Winterberry Holly	30-36", #5		
79	It	<i>Itea virginica</i>	Virginia Sweetspire	24-30", #5		Include (1) pollinator per grouping
516	Ra	<i>Rhus aromatica</i> 'Gro-low'	Gro-low Sumac	15-18", #3	36" o.c.	
15	Vd	<i>Viburnum dentatum</i> 'Blue Muffin'	Arrowwood Viburnum	36-48", #7	As Shown	
19	Vc	<i>Viburnum cassinoides</i>	Witherod Viburnum	4-5', #10		
26	Vn	<i>Viburnum nudum</i> 'Winterthur'	Winterthur Viburnum	36-48", #7		
6	Vp	<i>Viburnum prunifolium</i>	Blackhaw Viburnum	36-48", #7		
10	Vt	<i>Viburnum trilobum</i>	Cranberrybush Viburnum	4-5', #10	•	

Qty.	Key	Botanical Name	Common Name	Size	Spacing	Notes
BULBS						
1,000	Bulb A	<i>Allium 'Globemaster'</i>	Globemaster Ornamental Onion		Top Size	Contractor to install bulbs only in Fall season among Ornamental Grass plantings, in locations as directed by and Landscape Architect and Owner.
1,000	Bulb B	<i>Hyacinthoides non-scripta</i>	English Bluebells		Top Size	
1,000	Bulb C	<i>Narcissus 'February Gold'</i>	February Gold Daffodil		Top Size	
RIPARIAN RESTORATION						
92		<i>Cornus amomum</i>	Silky Dogwood	1-1/2" cal.	24" o.c.	Live Stake
92		<i>Cornus sericea</i>	Red Osier Dogwood	1-1/2" cal.	24" o.c.	Live Stake
51		<i>Salix discolor</i>	Pussy Willow	1-1/2" cal.	24" o.c.	Live Stake
51		<i>Salix eriocephala</i>	Heartleaf Willow	1-1/2" cal.	24" o.c.	Live Stake
243		<i>Sambucus canadensis</i>	Elderberry	1-1/2" cal.	24" o.c.	Live Stake
243		<i>Viburnum dentatum</i>	Arrowwood Viburnum	1-1/2" cal.	24" o.c.	Live Stake
243		<i>Viburnum lentago</i>	Nannyberry Viburnum	1-1/2" cal.	24" o.c.	Live Stake

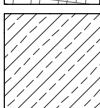
	3,741 SF	Wetland Meadow Mix (Mix E)	Seed	30 lb/acre	Ernst Conservation Seeds mix ERNMX-122
	11,442 SF	Seasonally Flooded Grass Mix (Mix A)	Seed	20 lb/acre	Ernst Conservation Seeds mix ERNMX-154
	6,706 SF	Native Wildflower & Grass Mix (Mix B)	Seed	20 lb/acre	Ernst Conservation Seeds mix ERNMX-153
	16,028 SF	Partially Shaded Woodland Mix (Mix C)	Seed	20 lb/acre	Ernst Conservation Seeds mix ERNMX-140
	21,832 SF	Lawn - Turf-type Tall Fescue Blend (Mix D)	Seed	20 lb/acre	

Note: Seed Mixes A, B & C above shall be drill-seeded for optimal germination. See specifications for additional information.

DISTRICT	COUNTY	ROUTE	SECTION	SHEET
6-0	PHILADELPHIA	-		8 OF 16
CITY OF PHILADELPHIA				
REVISION NUMBER	REVISIONS			DATE
				BY

SCHUYLKILL RIVER TRAIL EXTENSION
PLANTING PLAN - SHRUBS, PERENNIALS, GROUNDCOVER - 1

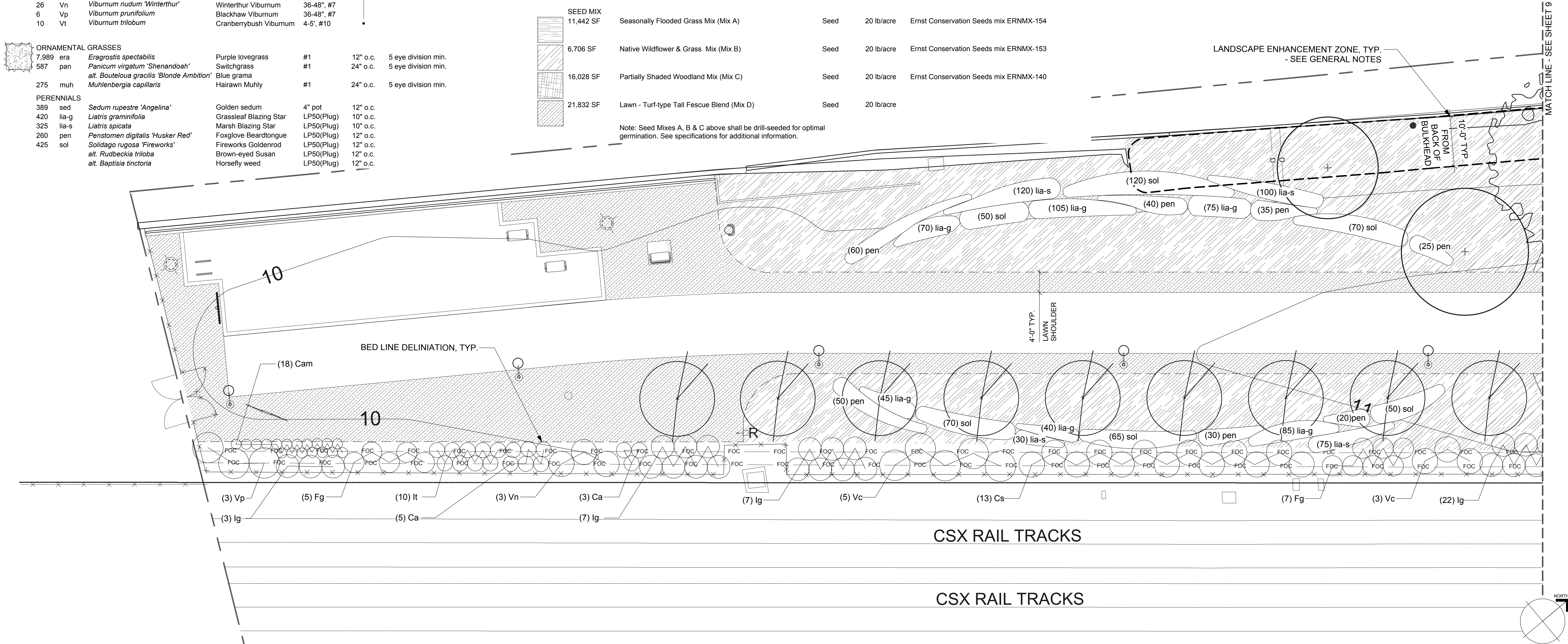

GENERAL NOTES:
1. LANDSCAPE ENHANCEMENT ZONE: CONTRACTOR TO PROVIDE PRUNING AND REMOVAL OF ALL DEAD, DISEASED, AND BROKEN TREE LIMBS, AND REMOVAL OF EXOTIC AND INVASIVE WOODY AND HERBACEOUS BRUSH PRIOR TO SEEDING. ALL DEBRIS SHALL BE REMOVED FROM SITE AND DISPOSED OF ACCORDING TO ALL APPLICABLE REGULATIONS. CONTRACTOR SHALL NOT OPERATE HEAVY MACHINERY WITHIN 10-FEET OF BULKHEAD OR TOP OF EMBANKMENT.
2. ALL TREES REMOVED WITHIN THIS ZONE TO BE FLUSH CUT AT GROUND-LEVEL (3" ABOVE FINISHED GRADE MAX.) AND ROOTBALL LEFT TO REMAIN. REFER TO SHEET 7 FOR TREES TO BE REMOVED. REFER TO SPECIFICATIONS FOR ADDITIONAL INFORMATION.
3. REFER TO SHEET 7 FOR TREE PLANTINGS. REFER TO SHEETS 8, 9, AND 10 FOR ALL OTHER PLANTINGS.

HORIZONTAL 0 10 20 FEET

SEAL: 
PA LA002810 12/2016
REGISTRATION NO. DATE
PREPARED BY:
Reconsidered Ground
LANDSCAPE ARCHITECT:
GROUND RECONSIDERED
230 S. BROAD ST., STE. 604
PHILADELPHIA, PA 19102
PH: 215.790.0727
www.groundreconsidered.com

DISTRICT	COUNTY	ROUTE	SECTION	SHEET	
6-0	PHILADELPHIA	-		9 OF 16	
CITY OF PHILADELPHIA					
REVISION NUMBER	REVISIONS			DATE	BY

SCHUYLKILL RIVER TRAIL EXTENSION
PLANTING PLAN - SHRUBS, PERENNIALS, GROUNDCOVER - 2

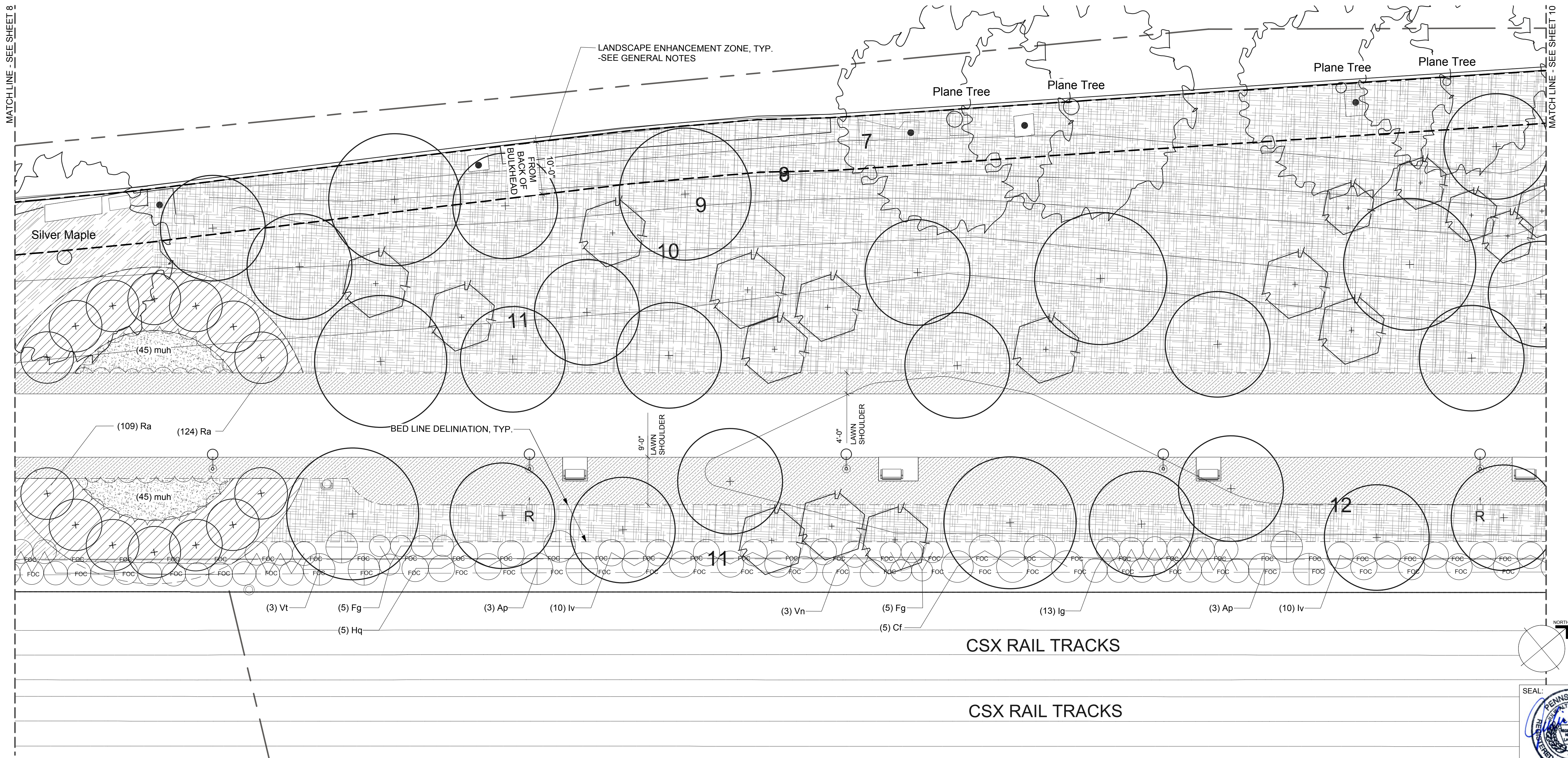

GENERAL NOTES:
1. LANDSCAPE ENHANCEMENT ZONE: CONTRACTOR TO PROVIDE PRUNING AND REMOVAL OF ALL DEAD, DISEASED, AND BROKEN TREE LIMBS, AND REMOVAL OF EXOTIC AND INVASIVE WOODY AND HERBACEOUS BRUSH PRIOR TO SEEDING. ALL DEBRIS SHALL BE REMOVED FROM SITE AND DISPOSED OF ACCORDING TO ALL APPLICABLE REGULATIONS. CONTRACTOR SHALL NOT OPERATE HEAVY MACHINERY WITHIN 10-FOET OF BULKHEAD OR TOP OF EMBANKMENT.
2. ALL TREES REMOVED WITHIN THIS ZONE TO BE FLUSH CUT AT GROUND-LEVEL (3" ABOVE FINISHED GRADE MAX.) AND ROOTBALL LEFT TO REMAIN. REFER TO SHEET 7 FOR TREES TO BE REMOVED. REFER TO SPECIFICATIONS FOR ADDITIONAL INFORMATION.
3. REFER TO SHEET 7 FOR TREE PLANTINGS. REFER TO SHEETS 8, 9, AND 10 FOR ALL OTHER PLANTINGS.

HORIZONTAL 0 10 20 FEET

SEAL: PENNSYLVANIA PROFESSIONAL LANDSCAPER ARCHITECT
PA LA002810 12/2016
REGISTRATION NO. DATE
PREPARED BY:
Ground Reconsidered
LANDSCAPE ARCHITECT:
GROUND RECONSIDERED
230 S. BROAD ST., STE. 604
PHILADELPHIA, PA 19102
PH: 215.790.0727
www.groundreconsidered.com

DISTRICT	COUNTY	ROUTE	SECTION	SHEET
6-0	PHILADELPHIA	-		10 OF 16
CITY OF PHILADELPHIA				
REVISION NUMBER	REVISIONS		DATE	BY

SCHUYLKILL RIVER TRAIL EXTENSION
PLANTING PLAN - SHRUBS, PERENNIALS, GROUNDCOVER - 3

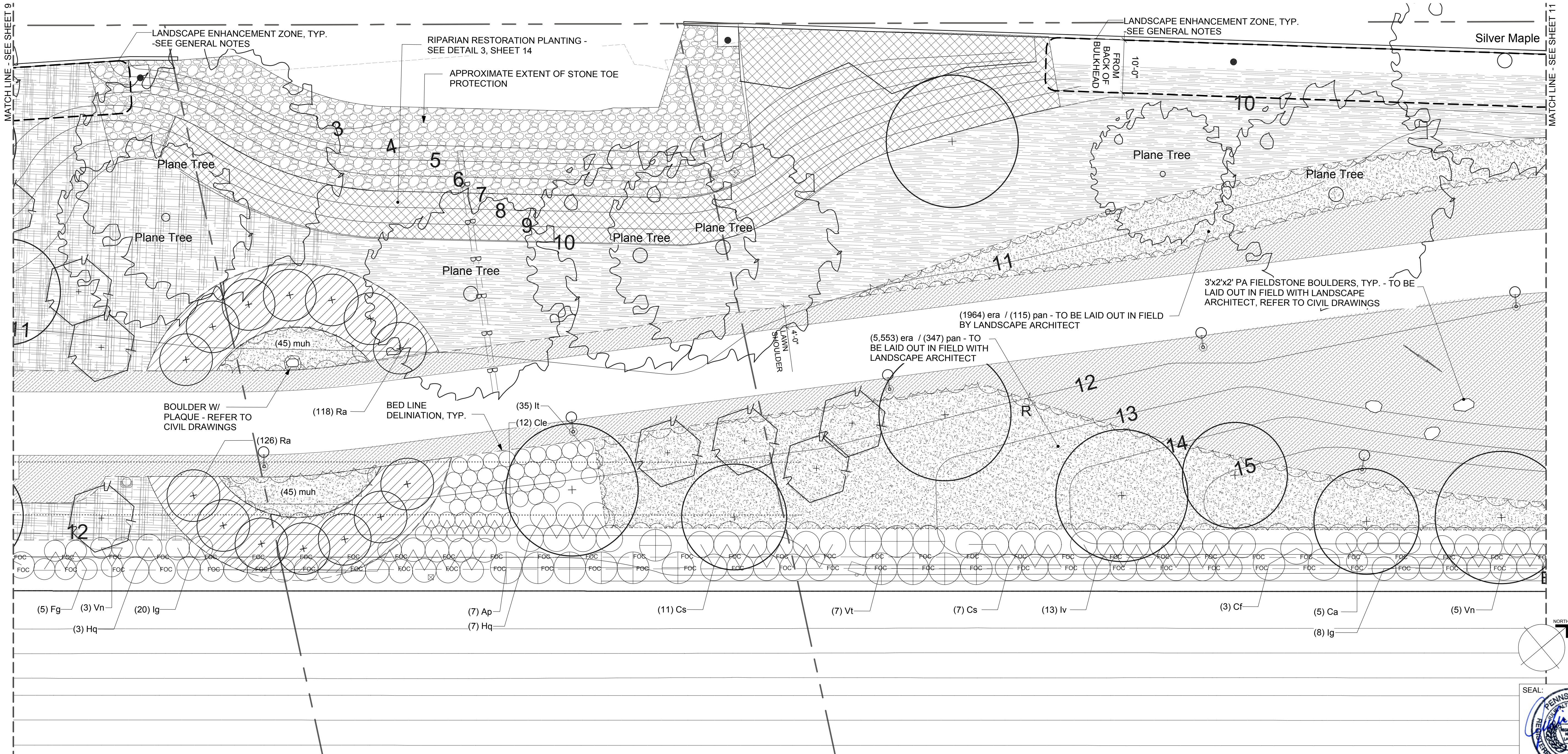

GENERAL NOTES:
1. LANDSCAPE ENHANCEMENT ZONE: CONTRACTOR TO PROVIDE PRUNING AND REMOVAL OF ALL DEAD, DISEASED, AND BROKEN TREE LIMBS, AND REMOVAL OF EXOTIC AND INVASIVE WOODY AND HERBACEOUS BRUSH PRIOR TO SEEDING. ALL DEBRIS SHALL BE REMOVED FROM SITE AND DISPOSED OF ACCORDING TO ALL APPLICABLE REGULATIONS. CONTRACTOR SHALL NOT OPERATE HEAVY MACHINERY WITHIN 10-FOOT OF BULKHEAD OR TOP OF EMBANKMENT.
2. ALL TREES REMOVED WITHIN THIS ZONE TO BE FLUSH CUT AT GROUND-LEVEL (3" ABOVE FINISHED GRADE MAX.) AND ROOTBALL LEFT TO REMAIN. REFER TO SHEET 7 FOR TREES TO BE REMOVED. REFER TO SPECIFICATIONS FOR ADDITIONAL INFORMATION.
3. REFER TO SHEET 7 FOR TREE PLANTINGS. REFER TO SHEETS 8, 9, AND 10 FOR ALL OTHER PLANTINGS.

SEAL:

PA LA002810 12/2016
REGISTRATION NO. DATE
PREPARED BY:
Ground Reconsidered
LANDSCAPE ARCHITECT:
GROUND RECONSIDERED
230 S. BROAD ST., STE. 604
PHILADELPHIA, PA 19102
PH: 215.790.0727
www.groundreconsidered.com

DISTRICT	COUNTY	ROUTE	SECTION	SHEET	
6-0	PHILADELPHIA	-		11 OF 16	
CITY OF PHILADELPHIA					
REVISION NUMBER	REVISIONS			DATE	BY

SCHUYLKILL RIVER TRAIL EXTENSION
PLANTING PLAN - SHRUBS, PERENNIALS, GROUNDCOVER - 4

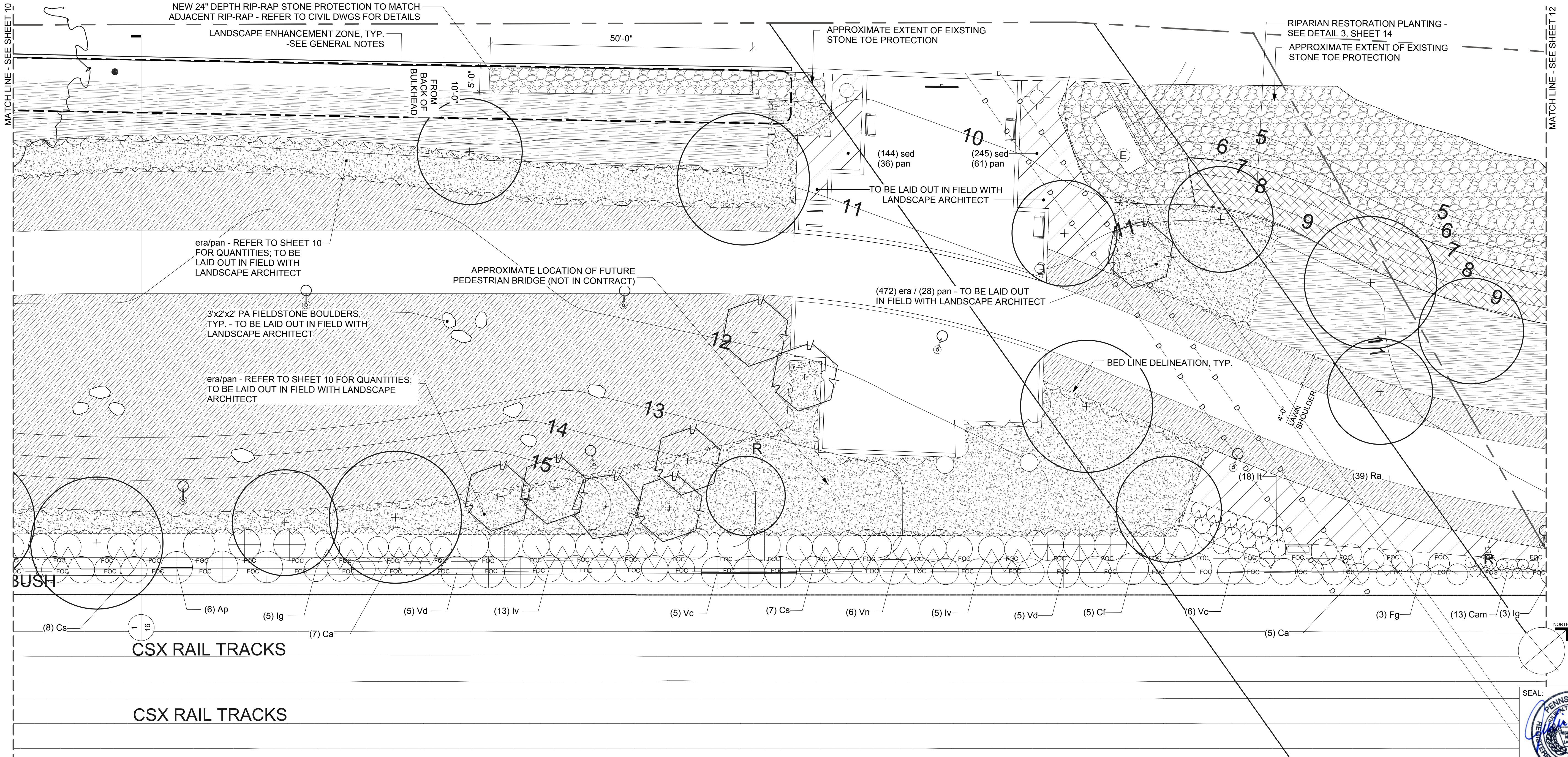

GENERAL NOTES:
1. LANDSCAPE ENHANCEMENT ZONE: CONTRACTOR TO PROVIDE PRUNING AND REMOVAL OF ALL DEAD, DISEASED, AND BROKEN TREE LIMBS, AND REMOVAL OF EXOTIC AND INVASIVE WOODY AND HERBACEOUS BRUSH PRIOR TO SEEDING. ALL DEBRIS SHALL BE REMOVED FROM SITE AND DISPOSED OF ACCORDING TO ALL APPLICABLE REGULATIONS. CONTRACTOR SHALL NOT OPERATE HEAVY MACHINERY WITHIN 10-FOET OF BULKHEAD OR TOP OF EMBANKMENT.
2. ALL TREES REMOVED WITHIN THIS ZONE TO BE FLUSH CUT AT GROUND-LEVEL (3" ABOVE FINISHED GRADE MAX.) AND ROOTBALL LEFT TO REMAIN. REFER TO SHEET 7 FOR TREES TO BE REMOVED. REFER TO SPECIFICATIONS FOR ADDITIONAL INFORMATION.
3. REFER TO SHEET 7 FOR TREE PLANTINGS. REFER TO SHEETS 8, 9, AND 10 FOR ALL OTHER PLANTINGS.

SEAL:

PA LA002810 12/2016
REGISTRATION NO. DATE
PREPARED BY:
Ground Reconsidered
LANDSCAPE ARCHITECT:
GROUND RECONSIDERED
230 S. BROAD ST., STE. 604
PHILADELPHIA, PA 19102
PH: 215.790.0727
www.groundreconsidered.com

DISTRICT	COUNTY	ROUTE	SECTION	SHEET
6-0	PHILADELPHIA	-		12 OF 16
CITY OF PHILADELPHIA				
REVISION NUMBER	REVISIONS		DATE	BY

SCHUYLKILL RIVER TRAIL EXTENSION
PLANTING PLAN - SHRUBS, PERENNIALS, GROUNDCOVER - 5

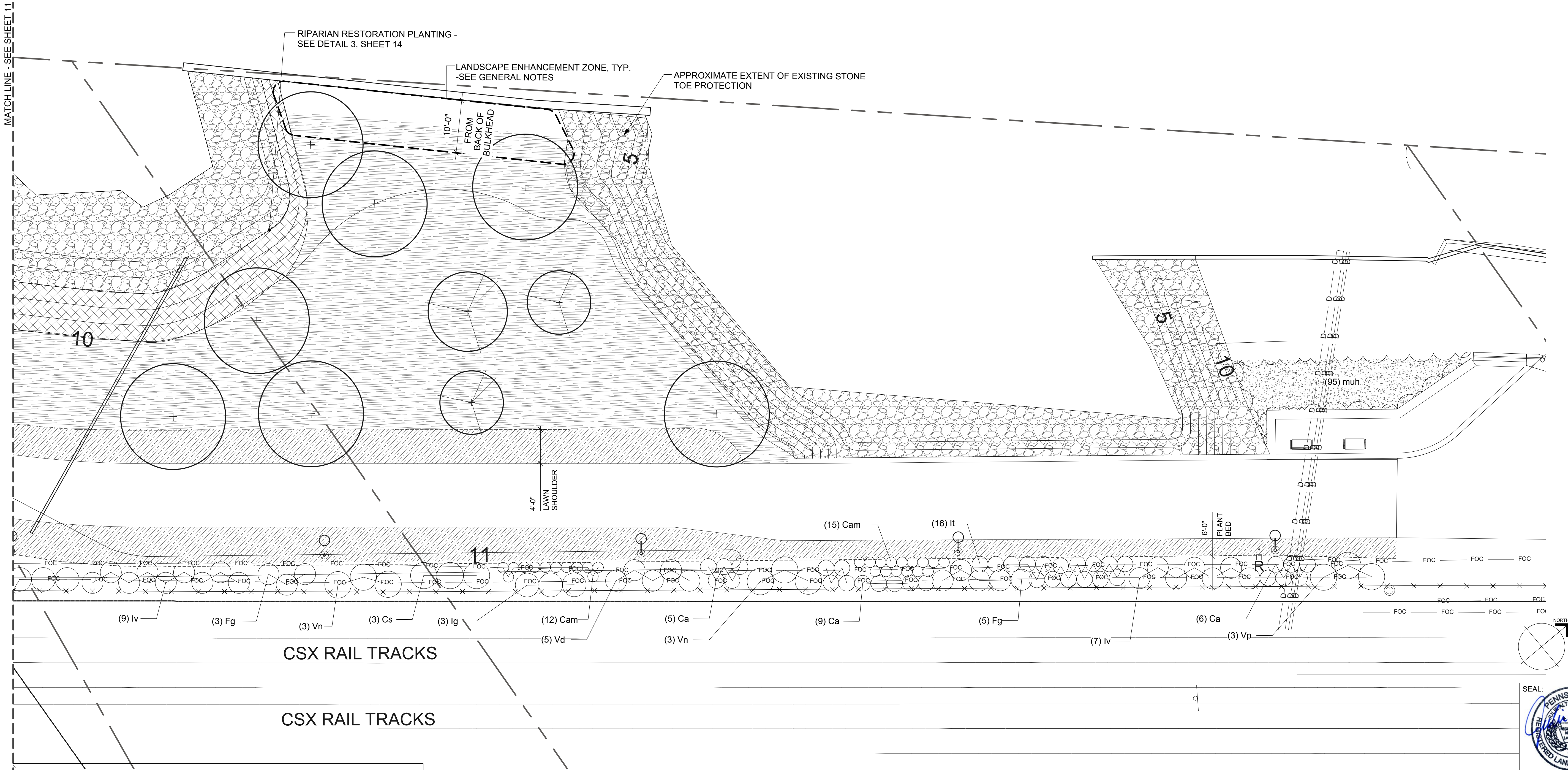

GENERAL NOTES:
1. LANDSCAPE ENHANCEMENT ZONE. CONTRACTOR TO PROVIDE PRUNING AND REMOVAL OF ALL DEAD, DISEASED, AND BROKEN TREE LIMBS, AND REMOVAL OF EXOTIC AND INVASIVE WOODY AND HERBACEOUS BRUSH PRIOR TO SEEDING. ALL DEBRIS SHALL BE REMOVED FROM SITE AND DISPOSED OF ACCORDING TO ALL APPLICABLE REGULATIONS. CONTRACTOR SHALL NOT OPERATE HEAVY MACHINERY WITHIN 10-FOET OF BULKHEAD OR TOP OF EMBANKMENT.
2. ALL TREES REMOVED WITHIN THIS ZONE TO BE FLUSH CUT AT GROUND-LEVEL (3" ABOVE FINISHED GRADE MAX.) AND ROOTBALL LEFT TO REMAIN. REFER TO SHEET 7 FOR TREES TO BE REMOVED. REFER TO SPECIFICATIONS FOR ADDITIONAL INFORMATION.
3. REFER TO SHEET 7 FOR TREE PLANTINGS. REFER TO SHEETS 8, 9, AND 10 FOR ALL OTHER PLANTINGS.

SEAL:

PA LA002810 12/2016
REGISTRATION NO. DATE
PREPARED BY:
Ground Reconsidered
LANDSCAPE ARCHITECT:
GROUND RECONSIDERED
230 S. BROAD ST., STE. 604
PHILADELPHIA, PA 19102
PH: 215.790.0727
www.groundreconsidered.com

DISTRICT	COUNTY	ROUTE	SECTION	SHEET
6-0	PHILADELPHIA	-		14 OF 16
CITY OF PHILADELPHIA				
REVISION NUMBER	REVISIONS		DATE	BY

SCHUYLKILL RIVER TRAIL EXTENSION
LANDSCAPE DETAILS

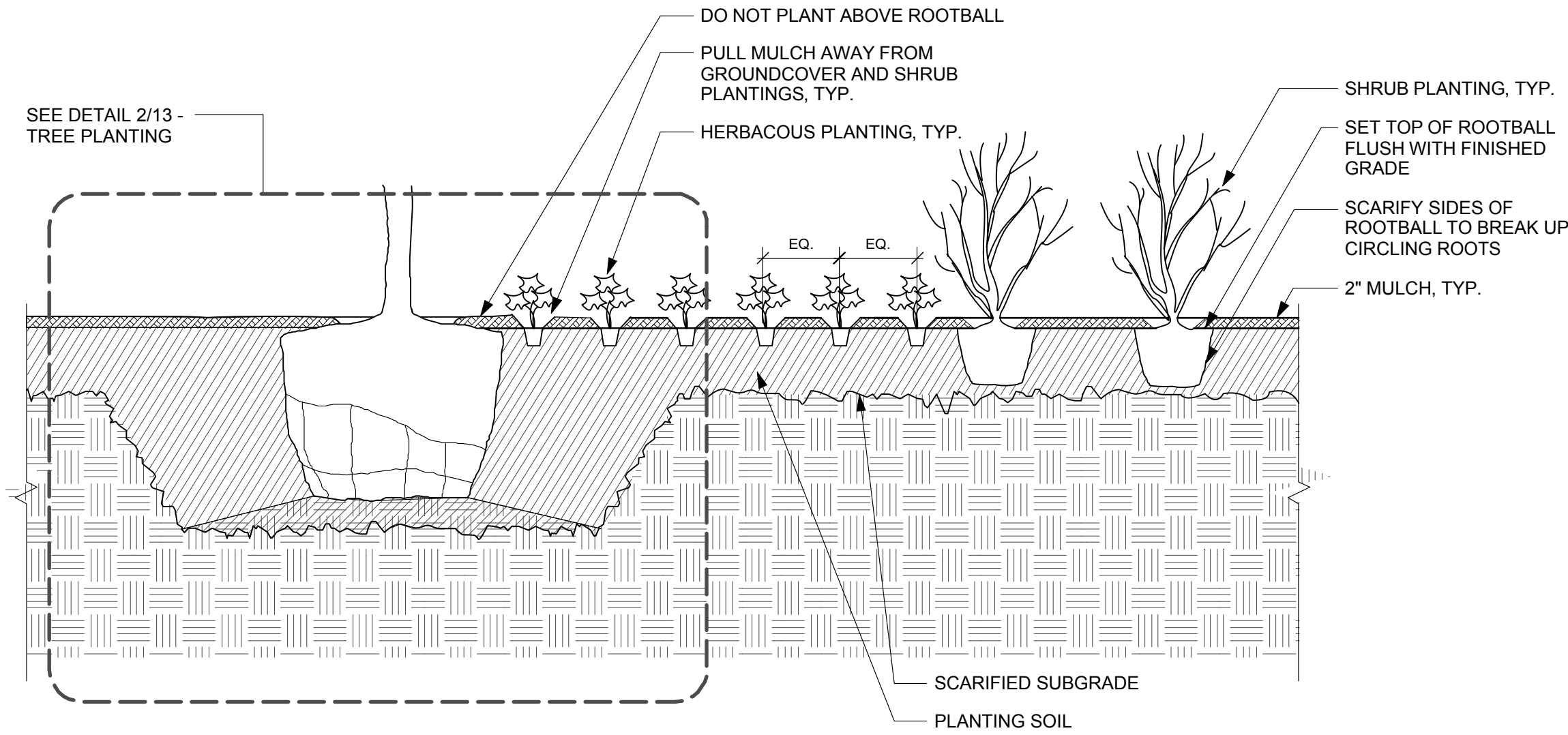

1 PERENNIAL PLANTING-TYPICAL
SCALE: 1/2"=1'0"

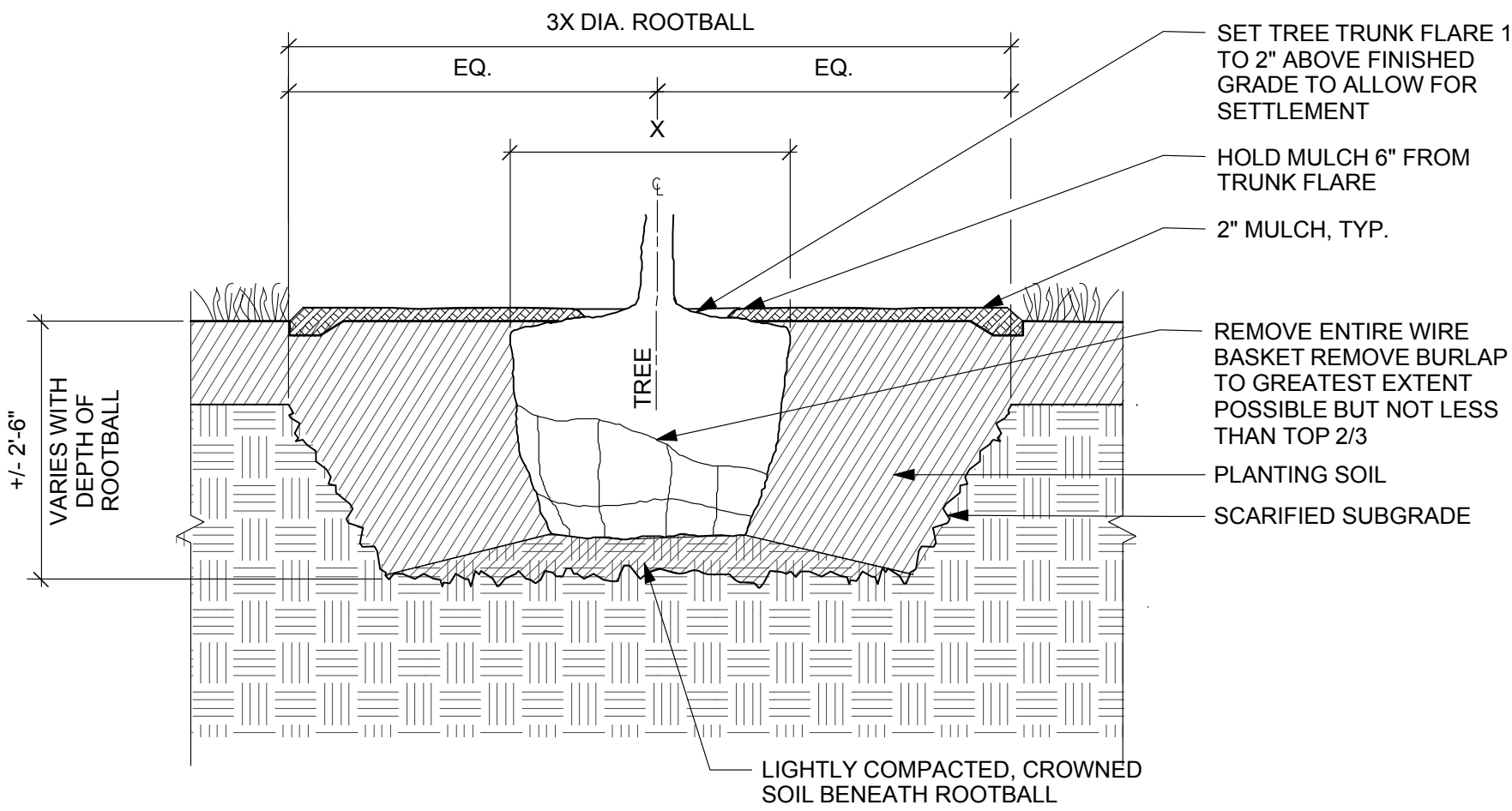

2 TREE PLANTING-TYPICAL
SCALE: 1/2"=1'0"

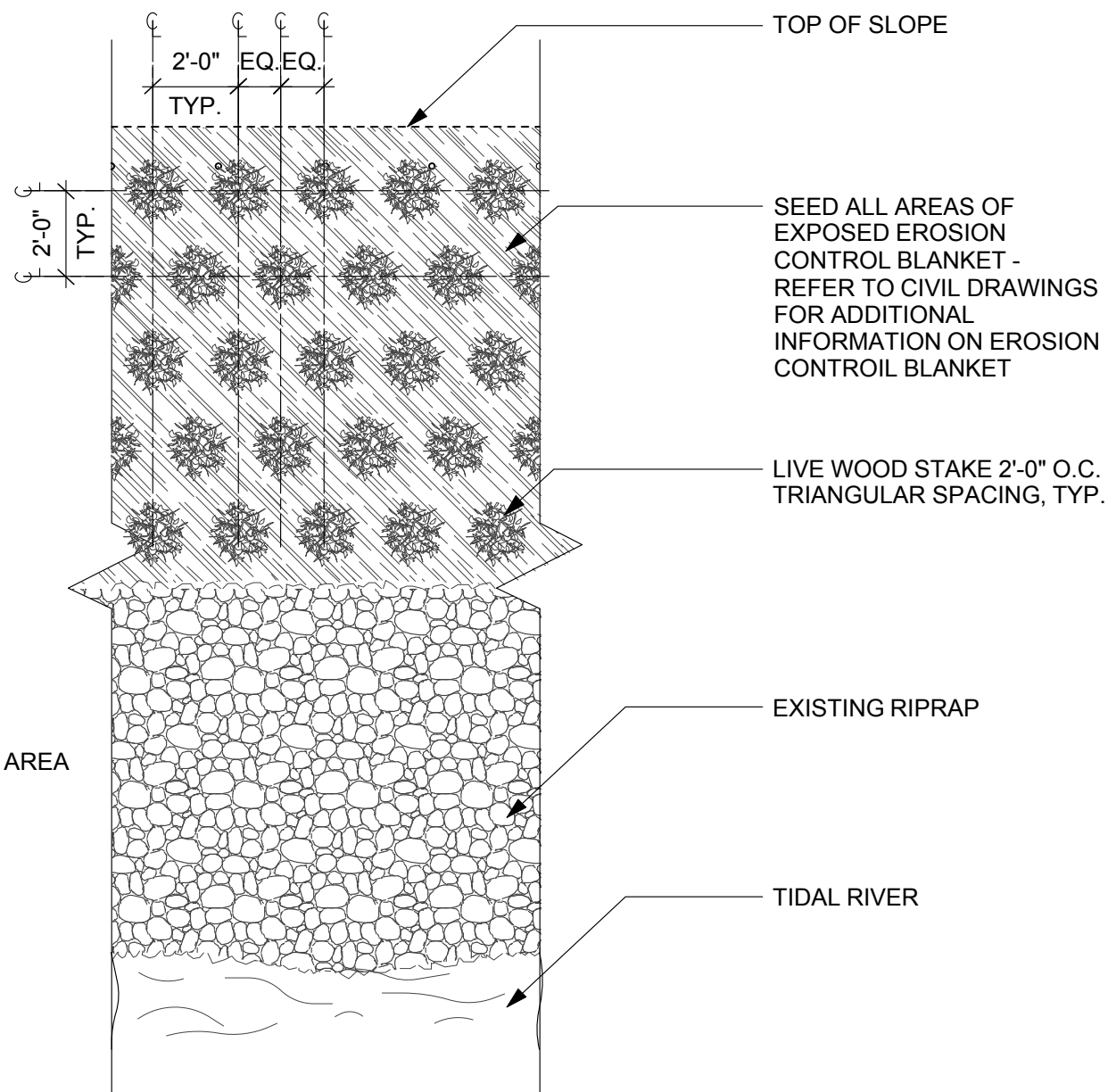

- NOTE:
1. SEED ALL EXPOSED EROSION CONTROL BLANKET AREA FOLLOWING LIVE STAKE INSTALLATION.
 2. SEE PLANT SCHEDULE, SHEET 9, FOR LIVE STAKE SPECIES AND SEED MIX.

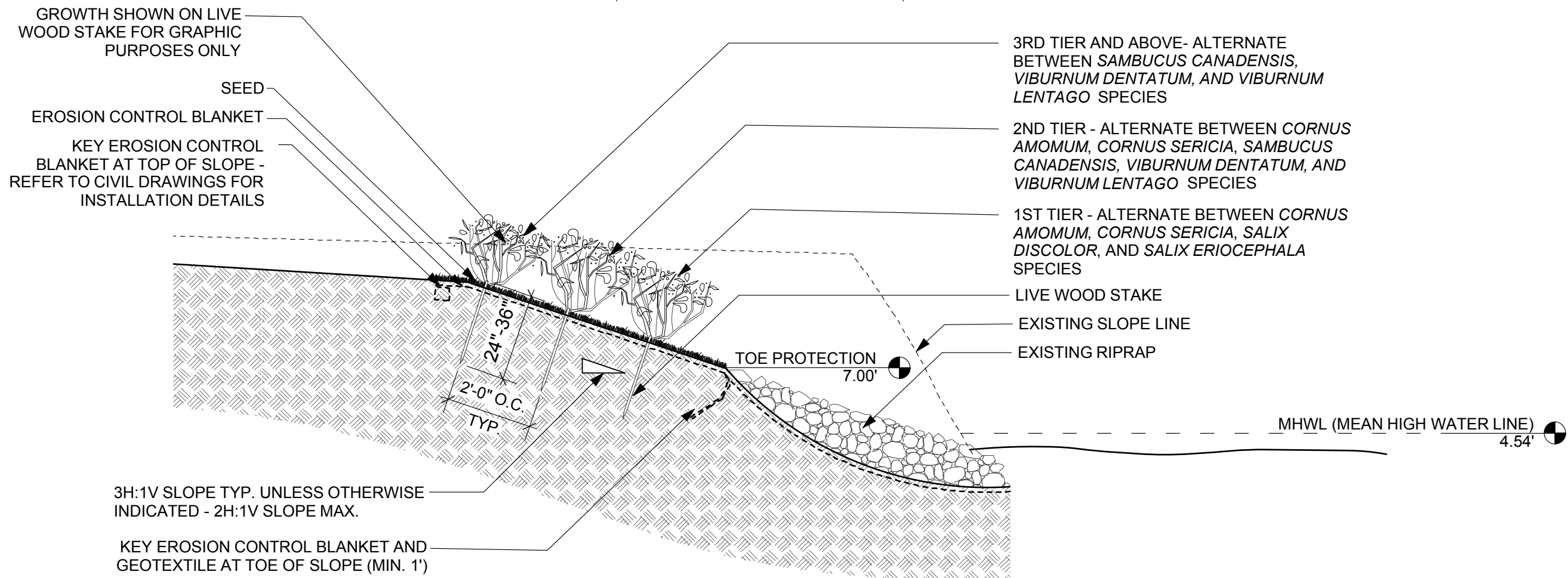

3 SLOPE STABILIZATION PLANTING - PLAN AND SECTION
SCALE: 1/2"=1'0"

DISTRICT	COUNTY	ROUTE	SECTION	SHEET
6-0	PHILADELPHIA	-		15 OF 16
CITY OF PHILADELPHIA				
REVISION NUMBER	REVISIONS		DATE	BY

SCHUYLKILL RIVER TRAIL EXTENSION
PLANTING SOIL DEPTH PLAN

SYMBOL KEY (PLANTING SOIL DEPTH)

- 6" DEPTH, PLANTING SOIL (LAWN)
- 6" DEPTH, ORGANIC SOIL AMENDMENT -ADDED TO EXISTING SOIL AND TILLED (MEADOW)
- 12" DEPTH, PLANTING SOIL (ORNAMENTAL GRASS)
- 18" DEPTH, PLANTING SOIL (SHRUB BUFFER)
- 30" DEPTH, PLANTING SOIL (LOCALIZED AT TREE PLANTINGS)
- RIPARIAN RESTORATION PLANTING (SEE DETAIL 3, SHEET 14)
- LANDSCAPE ENHANCEMENT ZONE: AMEND EXISTING SOIL IN-SITU WITH ORGANIC AMENDMENT. EXCAVATE SOIL ONLY AS REQUIRED FOR TREE OR SHRUB PLANTINGS.

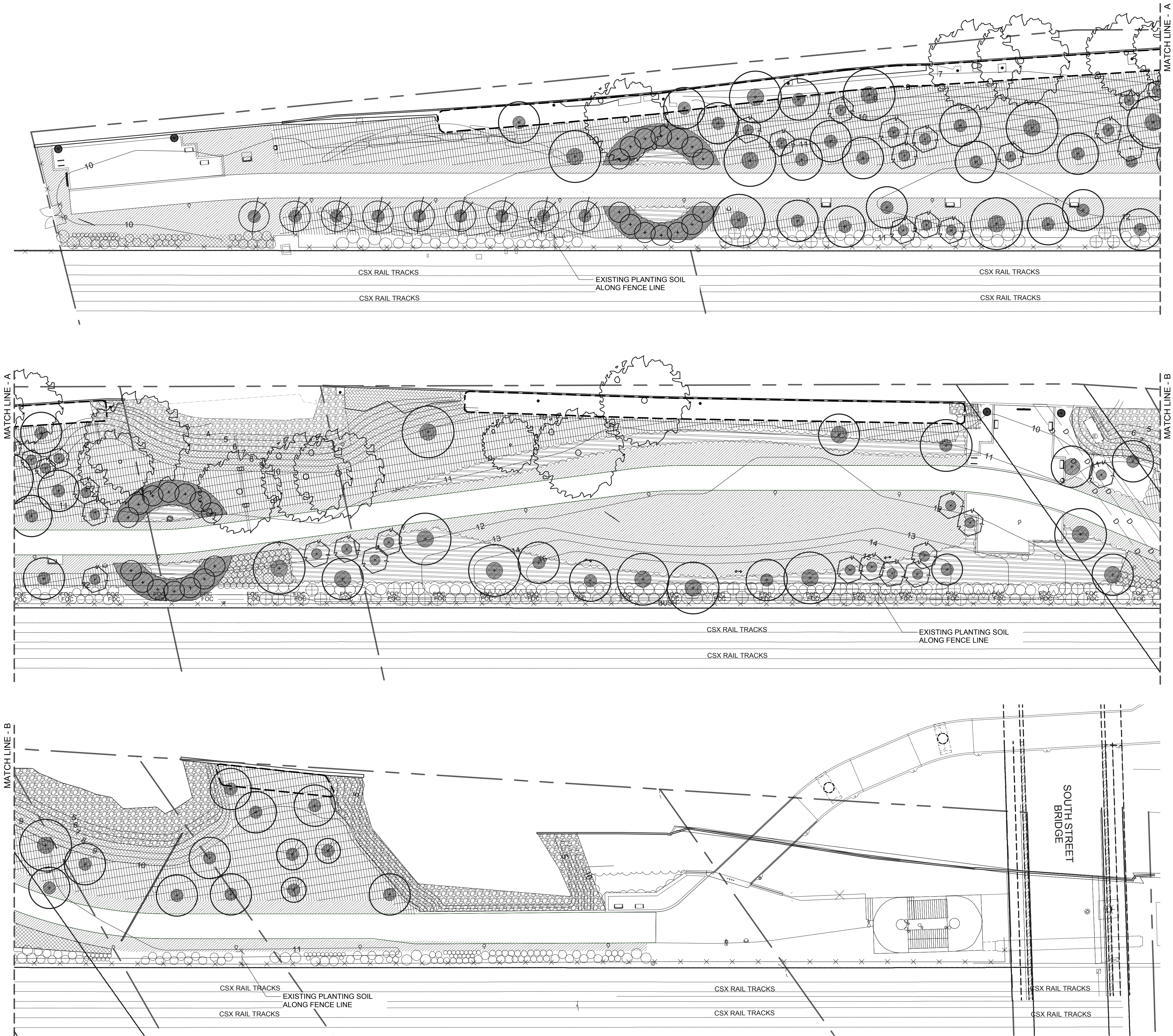

HORIZONTAL 0 25 50 FEET

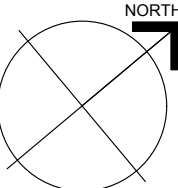

SEAL:

PA LA002810 12/2016
REGISTRATION NO. DATE
PREPARED BY:
Ground Reconsidered
LANDSCAPE ARCHITECT:
GROUND RECONSIDERED
230 S. BROAD ST., STE. 604
PHILADELPHIA, PA 19102
PH: 215.790.0727
www.groundreconsidered.com

DISTRICT	COUNTY	ROUTE	SECTION	SHEET
6-0	PHILADELPHIA	-		16 OF 16
CITY OF PHILADELPHIA				
REVISION NUMBER	REVISIONS		DATE	BY

SCHUYLKILL RIVER TRAIL EXTENSION
SECTIONS

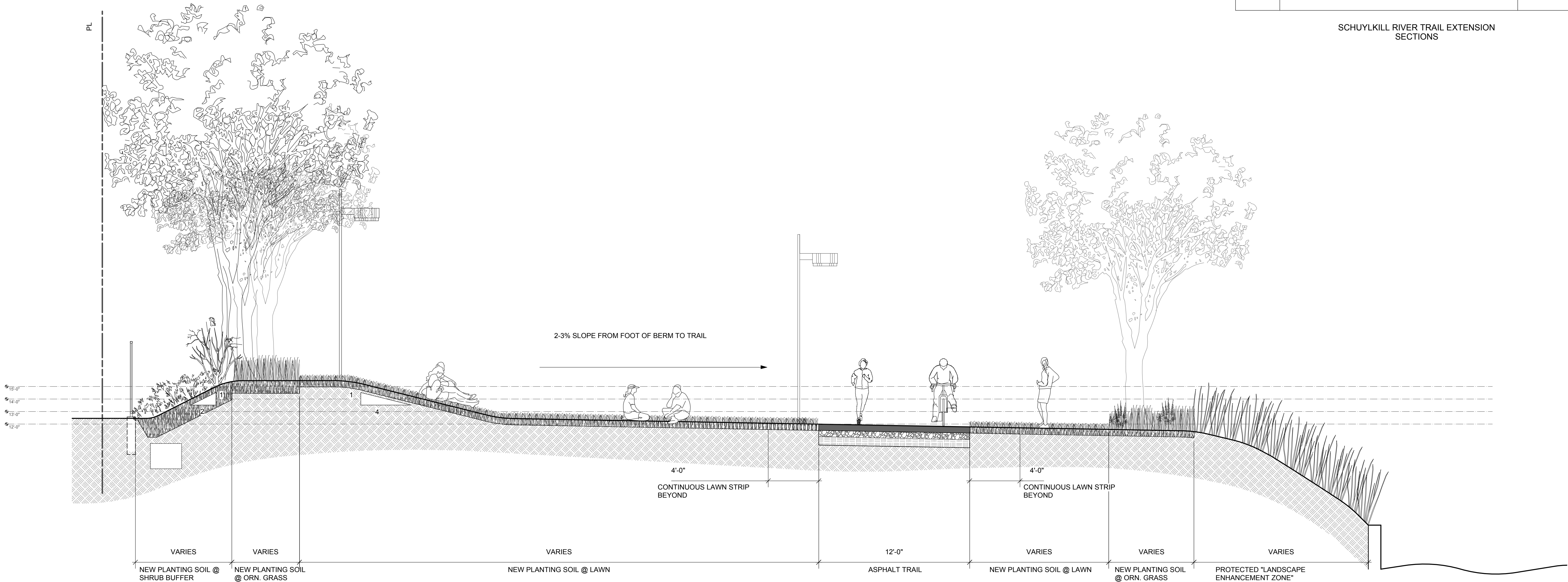

NOTE:
-CONTRACTOR TO INCLUDE GRADING/SHAPING OF BERM TO SHAPE /ALIGNMENT/HEIGHT AS DOCUMENTED
-REFER TO SHEETS 10 AND 11 FOR GRADING CONTOURS
-REFER TO SHEETS AND SHEET 15 FOR LIMITS OF NEW PLANTING SOILS AND DEPTHS

1 SECTION AT LAWN PANEL & BERM
16 SCALE: 1/4"= 1'-0"

SEAL:

PA LA002810 12/2016
REGISTRATION NO. DATE
PREPARED BY:
Ground Reconsidered
LANDSCAPE ARCHITECT:
GROUND RECONSIDERED
230 S. BROAD ST., STE. 604
PHILADELPHIA, PA 19102
PH: 215.790.0727
www.groundreconsidered.com